

**NEW PRODUCT PREVIEW**

# HXBSN 3A~3B Series Electric Actuators for Hazardous Locations, 3 Phase

**KEY FEATURES & BENEFITS**

- Designed for use in hazardous locations
- Available from 880”lbs up thru 1770”lbs
- 220/3, 380/3 and 480/3 are available, low voltage and single phase options also available
- Units are equipped with two (2) volt-free Form A Auxiliary switches
- Anti-Condensate heater standard
- ISO5211 compliant mechanical mount w/ double-square female drive socket
- Two (2) 3/4” EMT ports for ease of field wiring
- NEMA 4/4X/IP66 Compliant
- Visual position indicator
- Clutchless Hand Wheel override standard
- Collapsible spinner handle
- Torque switches standard

Notice: Due to certification regulations and traceability requirements, this product is non-cancellable and non-returnable. Verify the product and certifications are approved for the project prior to ordering.



**ATEX / IECEx CERTIFIED**  
 Ex II G Ex db IIB T4 Gb  
 Ex II D Ex tb IIIC T85°C / T100°C / T135°C Db

**TECHNICAL INFORMATION**

ACTUATOR SPECIFICATIONS		HXBSN3A	HXBSN3B
Supply	Torque Output (in-lb / Nm)	880 / 100	1770 / 200
220/3ph	Current Draw (Start / Run / LRA)	0.7A / 0.6A / 1.0A	0.7A / 0.6A / 1.0A
	Speed (90°) 60Hz / 50Hz, seconds	16 / 19	33 / 39
	Motor - 220V polyphase TENV	40W	40W
380/3ph	Current Draw (Start / Run / LRA)	0.4A / 0.3A / 0.6A	0.4A / 0.3A / 0.6A
	Speed (90°) 60Hz / 50Hz, seconds	16 / 19	33 / 39
	Motor - 380V polyphase TENV	40W	40W
480/3ph	Current Draw (Start / Run / LRA)	0.2A / 0.2A / 0.4A	0.2A / 0.2A / 0.4A
	Speed (90°) 60Hz / 50Hz, seconds	16 / 19	33 / 39
	Motor - 480V polyphase TENV	40W	40W
All	Electrical Entry (2)	3/4" EMT w/ Polyamide dust cap	
	Control	Basic, On/Off, Proportional	
	Auxiliary Switch - End of Travel	(2) Form A Volt-Free, Rated 10A @ 250vac	
	Ambient Operating Range	-40°F to +149°F (-40°C to +65°C)	
	Humidity Range	0-95% RH	
	Altitude Limit	9850 ft / 3000 m	

# HXBSN 3A~3B Series Electric Actuators for Hazardous Locations, 3 Phase

## TECHNICAL INFORMATION, CONTINUED



ATEX / IECEx CERTIFIED  
Ex II G Ex db IIB T4 Gb  
Ex II D Ex tb IIIC T85°C / T100°C / T135°C Db

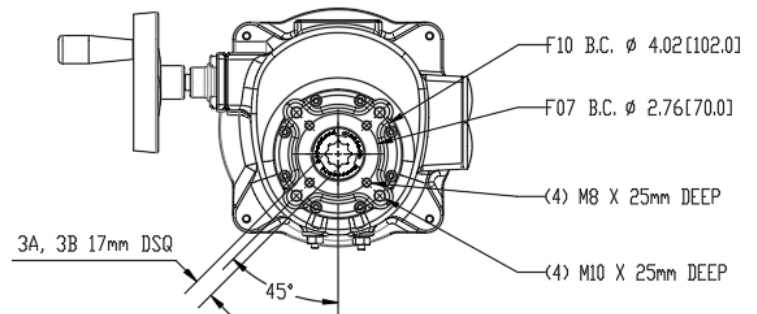
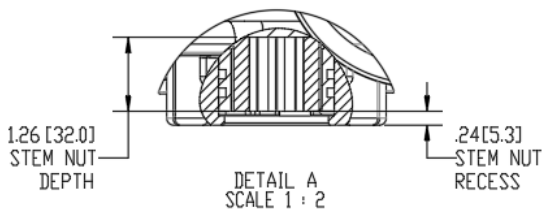
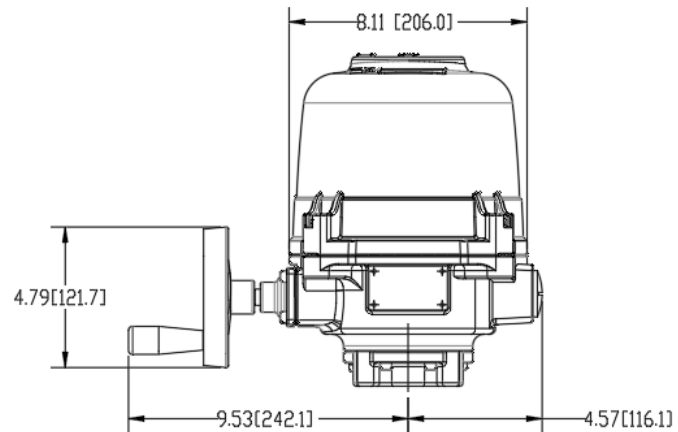
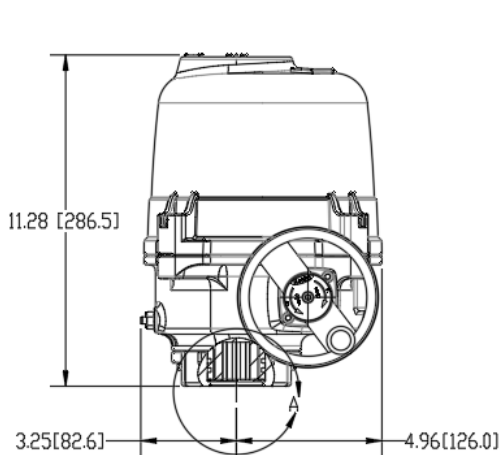

MODEL	COVER REMOVAL CLEARANCE		HANDWHEEL		WEIGHT
	IN/MM	IN/MM	# TURNS FOR 90°	LBS/KG	
HXBSN3A	8 / 200	4.79 / 122	12.5 turns 90°	34.1 / 15.5	
HXBSN3B	8 / 200	4.79 / 122	12.5 turns 90°	34.1 / 15.5	



Hayward is a registered trademark of Hayward Industries, Inc. © 2021 Hayward Industries, Inc.

NPP0821C

USA: 1.888.429.4635 • Fax: 1.888.778.8410 • One Hayward Industrial Drive • Clemmons, NC 27012 • Email: hfcsales@hayward.com  
Canada: 1.888.238.7665 • Fax: 1.905.829.3636 • 2880 Plymouth Drive • Oakville, ON L6H 5R4 • Email: hflowcanada@hayward.com  
Visit us at: haywardflowcontrol.com