



## SW Series Swing Check Valves

3" TO 6" / DN80 - 150 PVC, CPVC  
AND GFPP

8" / DN200 PVC AND GFPP

### KEY FEATURES

- Available in PVC, CPVC and GFPP
- High Temperature/Pressure Ratings
- Horizontal or Vertical Installation
- Two-in-One Seat Design
- Built-in Flange Seals
- Two Drain Ports
- Self-Aligning Clapper Seals
- High Cv Rating and Full Flow Design

### OPTIONS

- Counterweight for Closing Assistance

### MATERIALS

- PVC Cell Class 12454 per ASTM D1784
- CPVC Cell Class 23447 per ASTM D1784
- GFPP Cell Class 85580 per ASTM D4101
- FPM and EPDM O-Ring Seals

## TECHNICAL INFORMATION

### EXPLODED VIEW

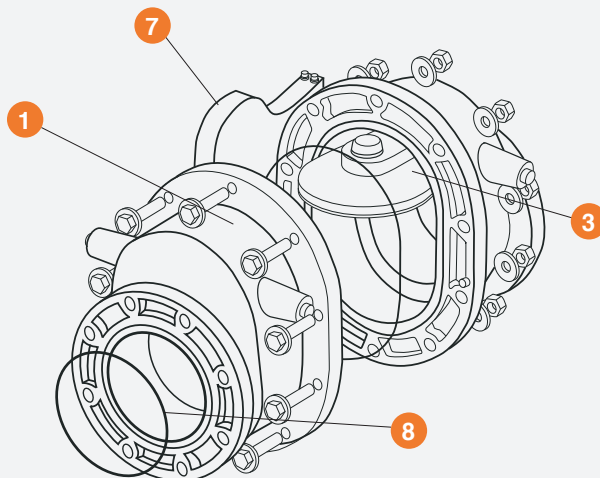

### SELECTION CHART

| SIZE                      | MATERIAL             | END CONNECTION | SEALS          | PRESSURE RATING                              |
|---------------------------|----------------------|----------------|----------------|----------------------------------------------|
| 3" - 6"<br>(DN80 - DN150) | PVC, CPVC<br>or GFPP | Flanged        | FPM or<br>EPDM | 150 PSI @ 70°F<br>10 Bar @ 21°C<br>Non-Shock |
| 8"<br>(DN200)             | PVC or<br>GFPP       |                |                |                                              |

\* Fits both ANSI150 and PN10 Flanges.

# SW Series Swing Check Valves

3" TO 6" / DN80 - 150 PVC, CPVC AND GFPP

8" / DN200 PVC AND GFPP

## TECHNICAL INFORMATION, CONTINUED

### PARTS LIST

1. Body
2. Swing Arm
3. Clapper
4. Shaft\*
5. Body Seal
6. Drain Plug (2)
7. Counter Weight (Optional)
8. O-Ring Face Seal

\* PVC with PVC valves  
 PVDF with GFPP Valves  
 CPVC with CPVC valves

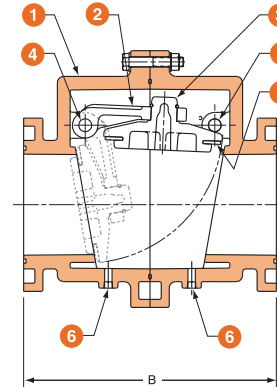
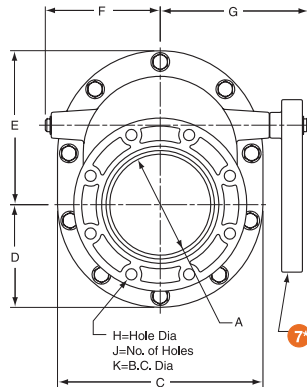

### DIMENSIONS

| SIZE<br>in / DN | A<br>in / mm | B<br>in / mm | C<br>in / mm | D<br>in / mm | E<br>in / mm | F<br>in / mm | G<br>in / mm | H<br>in / mm | J | K<br>in / mm | WEIGHT<br>lbs / kg | MINIMUM BACK<br>PRESSURE TO<br>SEAL - PSI |
|-----------------|--------------|--------------|--------------|--------------|--------------|--------------|--------------|--------------|---|--------------|--------------------|-------------------------------------------|
| 3 / 80          | 3.00 / 76    | 10.24 / 260  | 7.50 / 191   | 3.75 / 95    | 5.21 / 132   | 3.90 / 99    | 4.91 / 125   | .75 / 19     | 4 | 6.00 / 152   | 10.00 / 4.54       | 3                                         |
| 4 / 100         | 3.90 / 99    | 11.81 / 300  | 9.25 / 235   | 4.63 / 118   | 6.75 / 171   | 4.80 / 122   | 6.15 / 156   | .75 / 19     | 8 | 7.50 / 191   | 21.00 / 9.53       | 3                                         |
| 6 / 150         | 5.91 / 150   | 15.75 / 400  | 12.75 / 324  | 6.38 / 162   | 9.25 / 235   | 6.47 / 164   | 8.30 / 211   | .88 / 22     | 8 | 9.50 / 241   | 47.00 / 21.32      | 3                                         |
| 8 / 200         | 7.87 / 200   | 19.69 / 500  | 16.00 / 406  | 8.00 / 203   | 12.00 / 305  | 8.96 / 228   | 11.54 / 293  | .88 / 22     | 8 | 11.75 / 298  | 90.00 / 40.82      | 3                                         |

Dimensions are subject to change without notice – consult factory for installation information

### Cv VALUES

| SIZE<br>in / DN | Cv VALUES | SIZE<br>in / DN | Cv VALUES |
|-----------------|-----------|-----------------|-----------|
| 3 / 80          | 328       | 6 / 150         | 1,278     |
| 4 / 100         | 514       | 8 / 250         | 2,549     |

### PRESSURE LOSS CALCULATION FORMULA

$$\Delta P = \left[ \frac{Q}{C_v} \right]^2$$

$\Delta P$  = Pressure Drop  
 $Q$  = Flow in GPM  
 $C_v$  = Flow Coefficient

### OPERATING TEMPERATURE/PRESSURE

#### 3" TO 8" SWING CHECK VALVE

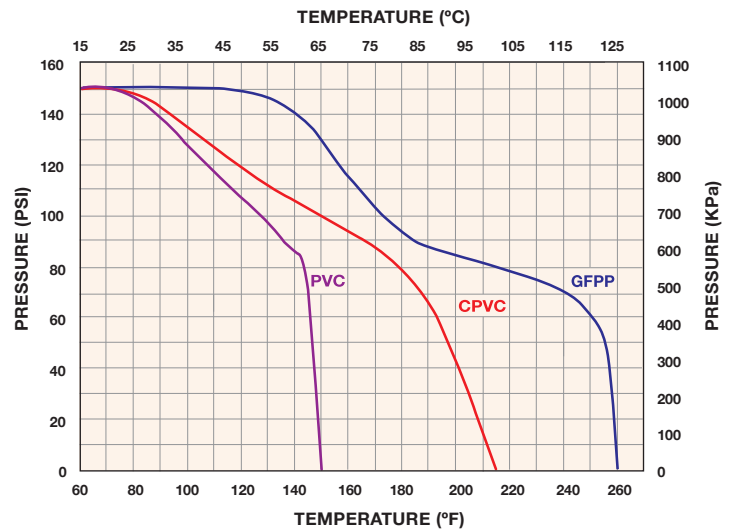

Hayward is a registered trademark  
 of Hayward Industries, Inc.  
 © 2026 Hayward Industries, Inc.

Contact Hayward Flow Control with questions:

USA: 1.888.429.4635 • Fax: 1.888.778.8410 • One Hayward Industrial Drive • Clemmons, NC 27012 • Email: hfcsales@hayward.com  
 Canada: 1.888.238.7665 • Fax: 1.905.829.3636 • 2880 Plymouth Drive • Oakville, ON L6H 5R4 • Email: hflowcanada@hayward.com

Visit us at: haywardflowcontrol.com