

NEW PRODUCT PREVIEW
UVH Series UV Sanitizer

120 kW-1200 kW / 46-1141 GPM

TYPE 316L SS

KEY FEATURES

- Easy to Install - Vertically or Horizontally
- Z (In-line) or U (Loop) Flow Configuration
- 254 nm & 185 nm Dual Wavelength High Output Amalgam Lamps
- 13,000 Hour Lamp Life
- Quick Disconnects for Easy Lamp Replacement
- 120V, 60 Hz Power Requirement

Safety Sensors For:

- Missing Safety Cover
- No Flow
- Loss of Lamp Illumination

MATERIALS

- Type 316L Stainless Steel
- Quartz Lamp Sleeves

CERTIFICATIONS

- NSF-50 Certified
- UL-1081 Certified
- CSA-C22.2 Certified

TECHNICAL INFORMATION

MODEL	TYPE	LAMPS	END CONN	POWER	AMP DRAW	FLOW RATE @ 45 mJ/cm ² dose	TRANSMITTANCE
120 kW	Supplemental	1	2" FLNG	120 V SINGLE PHASE	1.2	46 GPM	95%
	Secondary						
240 kW	Supplemental	2	3" FLNG		2.4	119 GPM	
	Secondary						
480 kW	Supplemental	4	4" FLNG		4.8	352 GPM	
	Secondary						
720 kW	Supplemental	6	6" FLNG		7.2	620 GPM	
	Secondary						
960 kW	Supplemental	8	6" FLNG		9.6	770 GPM	
	Secondary						
1200 kW	Supplemental	10	8" FLNG	12	1141 GPM		
			10" FLNG				
	Secondary		8" FLNG				
			10" FLNG				

Technical Note:

- Maximum operating pressure: 50 psi/3.5 bar
- Operating Temperature: 40°F (4°C) to 104°F (40°C)

UVH Series UV Sanitizer

120 kW- 1200 kW / 46-1141 GPM

TECHNICAL INFORMATION, CONTINUED

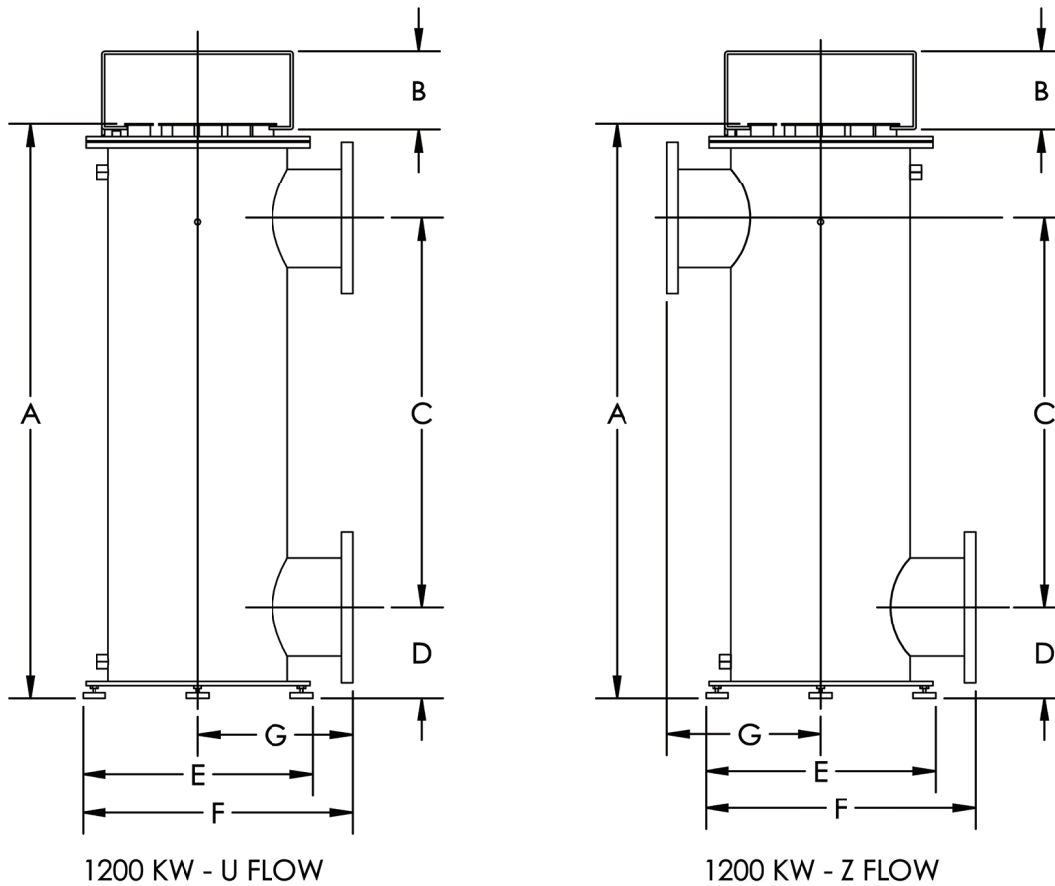

DIMENSIONS

MODEL	A in/mm	B in/mm	C in/mm	D in/mm	E in/mm	F in/mm	G in/mm	END CONN
120 kW - SS	43.25/ 1098.55	7/ 177.80	33.19/ 843.03	4.88/ 123.95	9/ 228.60	9.75/ 247.65	5.25/ 133.35	2" FLANGE
240 kW - SS	43.25/ 1098.55	7/ 177.80	32/ 812.80	5.5/ 139.70	11.13/ 282.70	12.63/ 320.80	7.06/ 179.32	3" FLANGE
480 kW - SS	47.25/ 1200.15	7/ 177.80	35/ 889.00	6/ 152.40	15.25/ 387.35	17.75/ 450.85	10.13/ 257.30	4" FLANGE
720 kW - SS	51.25/ 1301.75	7/ 177.80	36.88/ 936.75	7.06/ 179.32	17.25/ 438.15	20.5/ 520.70	11.88/ 301.75	6" FLANGE
960 kW - SS	51.25/ 1301.75	7/ 177.80	36.88/ 936.75	7.06/ 179.32	17.25/ 438.15	20.5/ 520.70	11.88/ 301.75	6" FLANGE
1200 kW - SS	51.25/ 1301.75	7/ 177.80	34.75/ 882.65	8.13/ 206.50	20.50/ 520.70	24/ 609.60	13.75/ 349.25	8" or 10" FLANGE



Hayward is a registered trademark of Hayward Industries, Inc.
© 2026 Hayward Industries, Inc.

NPP0226B